

SMD POWER INDUCTORS:

HSC1250 Series

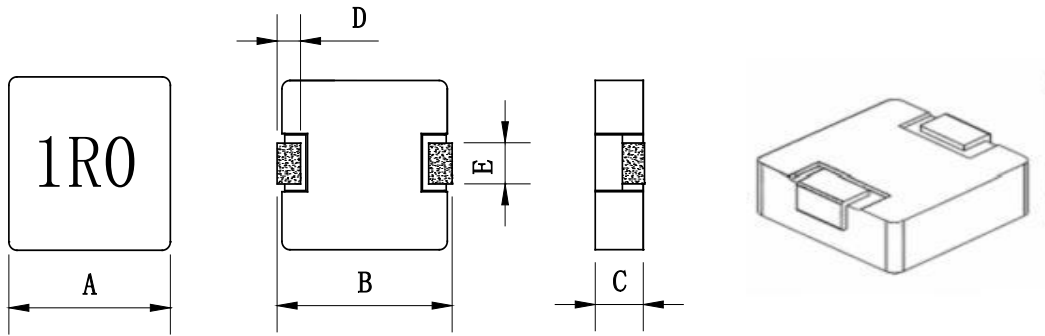

Series	A (mm)	B (mm)	C (mm)	D (mm)	E (mm)
HSC1250	12.8±0.5	13.2±1.0	5.0MAX	2.5±0.5	3.8±0.2

Part Number	L0 Inductance (μH) ±20%	Heat Rating Current Irms (A)	Saturation Current Isat (A)	DCR (mΩ)	
				TYP.	MAX.
HSC1250-R36M-G/B	0.36	30.0	55.0	1	1.2
HSC1250-R47M-G/B	0.47	25.0	50.0	1.2	1.4
HSC1250-R56M-G/B	0.56	23.0	45.0	1.3	1.5
HSC1250-R68M-G/B	0.68	20.0	40.0	1.7	2.1
HSC1250-R82M-G/B	0.82	18.0	35.0	1.9	2.3
HSC1250-1R0M-G/B	1.0	16.0	32.0	2.3	2.7
HSC1250-1R2M-G/B	1.2	16.0	30.0	2.6	3.0
HSC1250-1R5M-G/B	1.5	14.0	27.0	3.7	4.1
HSC1250-2R2M-G/B	2.2	13.0	25.0	4.9	5.5
HSC1250-3R3M-G/B	3.3	12.0	24.0	6.1	6.9
HSC1250-4R7M-G/B	4.7	11.0	21.0	11.6	13.0
HSC1250-5R6M-G/B	5.6	9.5	18.0	13.6	16.0
HSC1250-6R8M-G/B	6.8	8.0	15.0	15.7	18.5
HSC1250-8R2M-G/B	8.2	7.0	13.0	18.4	24.0
HSC1250-100M-G/B	10.0	7.5	12.5	20.0	25.5

*: you require another part number please contact with us.

** : Inductance Tolerance ± 20%

Note 1: All test data is referenced to 25°C ambient.

Note 2: I_{dc} : DC current (A) that will cause an approximate ΔT of 40°C

Note 3: I_{sat} : DC current (A) that will cause L_o to drop approximately 30%

SMD POWER INDUCTORS:

HSC-1250M Series

1. Reel Dimension

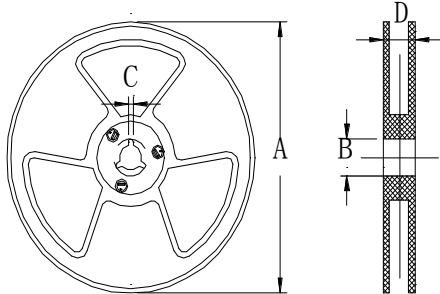

规格尺寸	13"
A	$\Phi 330 \pm 2.0$ (mm)
B	$\Phi 76.5 \pm 2.0$ mm
C	$\Phi 2.3$ mm
D	24.0 上载带 21.3 ± 0.15 mm)

2. Tape Dimension

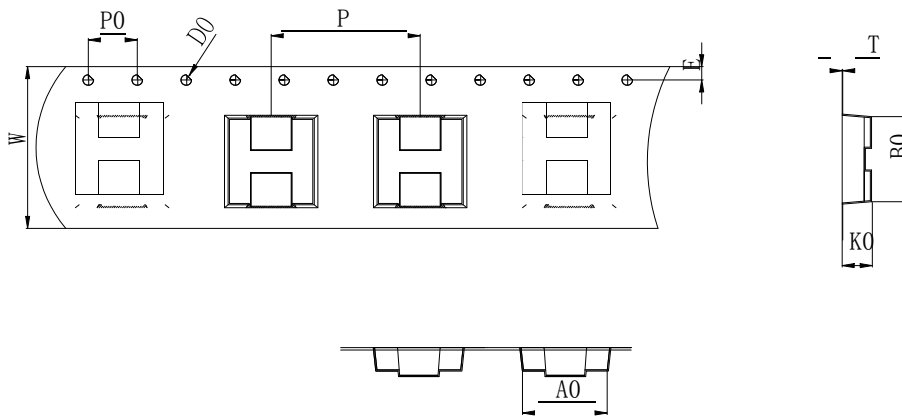

Size	W (mm)	A0 (mm)	B0 (mm)	D0 (mm)	E (mm)	K0 (mm)	P0 (mm)	P (mm)	T (mm)
1250	24.0 ± 0.3	13.1 ± 0.1	14.1 ± 0.1	1.5 ± 0.1	1.75 ± 0.1	5.0 ± 0.1	4.0 ± 0.1	20.0 ± 0.1	0.4 ± 0.05

3. Packaing Quantity

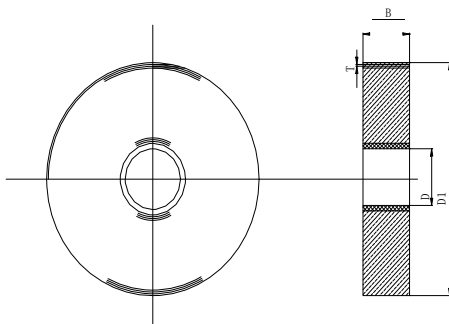

包装单位	包装尺寸	包装数量
1 盘	330*29mm	500pcs
1 盒/2 盘	34*6.5*34cm	1000pcs
1 箱/2 盒	35.5*28.5*36.5cm	2000pcs