

**SMD POWER INDUCTORS:** HSC0624 Series

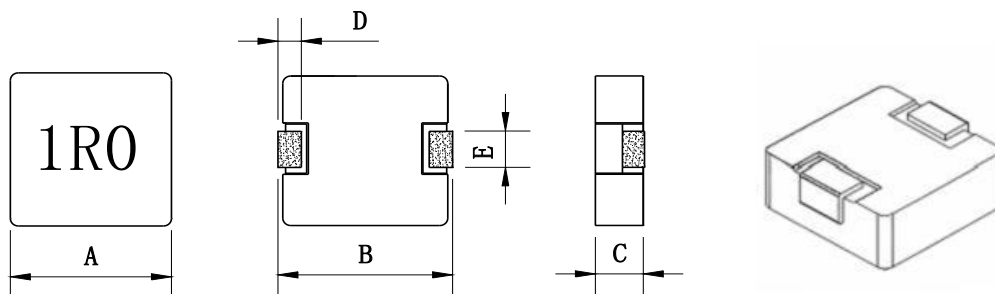

Series	A (mm)	B (mm)	C (mm)	D (mm)	E (mm)
HSC6024	6.6±0.2	7.4MAX	2.4MAX	1.6±0.3	3.0±0.2

Part Number	L0 Inductance (μH) ±20%	Heat Rating Current I <sub>rms</sub> (A)	Saturation Current I <sub>sat</sub> (A)	DCR (mΩ)	
				TYP.	MAX.
HSC6024-R47M-G/B	0.47	14.0	19.0	5.7	6.5
HSC6024-R68M-G/B	0.68	11.5	18.0	7.9	9.4
HSC6024-R82M-G/B	0.82	10.5	16.0	9.6	11.8
HSC6024-1R0M-G/B	1.0	10.0	15.0	12.5	14.2
HSC6024-1R5M-G/B	1.5	8.0	13.0	17.4	21.2
HSC6024-2R2M-G/B	2.2	6.0	12.0	28.0	34.0
HSC6024-3R3M-G/B	3.3	4.5	9.0	45.0	51.0
HSC6024-4R7M-G/B	4.7	4.0	7.5	57.0	63.0
HSC6024-6R8M-G/B	6.8	3.0	6.0	83.0	95.0
HSC6024-8R2M-G/B	8.2	2.5	5.0	94.0	106.0
HSC6024-100M-G/B	10.0	2.0	4.0	108.0	130.0

\*: you require another part number please contact with us.

\*\* : Inductance Tolerance ± 20%

Note 1: All test data is referenced to 25°C ambient.

Note 2: I<sub>dc</sub> : DC current (A) that will cause an approximate ΔT of 40°C

Note 3: I<sub>sat</sub> : DC current (A) that will cause L<sub>o</sub> to drop approximately 30%

# SMD POWER INDUCTORS:

HSC-6024M Series

## 1. Reel Dimension

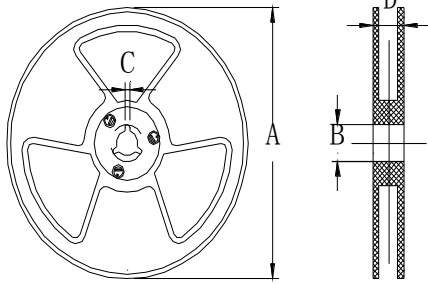

规格	13"
尺寸	
A	$\Phi 330 \pm 2.0\text{mm}$
B	$\Phi 76.5 \pm 2.0\text{mm}$
C	2.3mm
D	16mm (载带 $13.3 \pm 0.15\text{mm}$ )

## 2. Tape Dimension

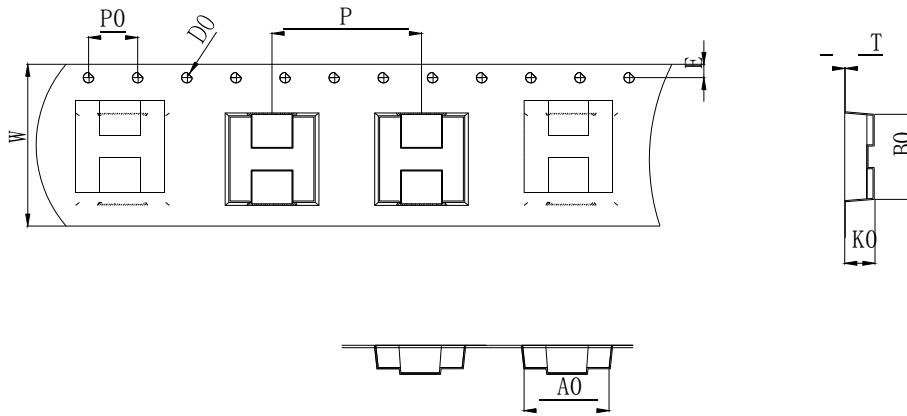

Size	W (mm)	A0 (mm)	B0 (mm)	D0 (mm)	E (mm)	K0 (mm)	P0 (mm)	P (mm)	T (mm)
6024	$16.0 \pm 0.3$	$6.8 \pm 0.1$	$7.3 \pm 0.1$	$1.5 \pm 0.1$	$1.75 \pm 0.1$	$2.4 \pm 0.1$	$4.0 \pm 0.1$	$12.0 \pm 0.1$	$0.3 \pm 0.05$

## 3. Packaing Quantity

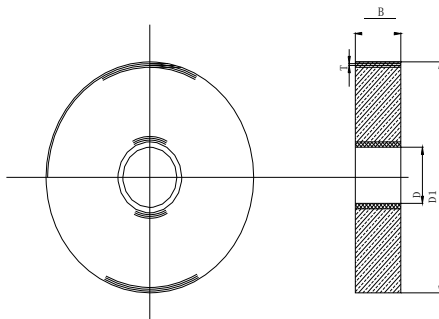

包装单位	包装尺寸	包装数量
1 盘	330*29mm	2000pcs
1 盒3 盘	34*6.5*34cm	6000pcs
1 箱2 盒	35.5*28.5*36.5cm	12000pcs