

SMD POWER INDUCTORS: HSC5030 Series

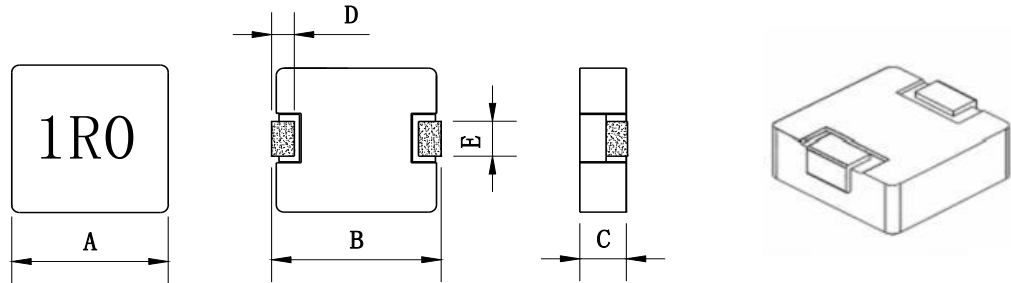

Series	A(mm)	B(mm)	C(mm)	D(mm)	E(mm)
HSC5030	5.18±0.3	5.45±0.4	3.0MAX	1.2±0.3	2.3±0.2

Part Number	L0 Inductance (μH) ± 20%	Heat Rating Current Irms(A)	Saturation Current Isat (A)	DCR (mΩ)	
				TYP.	MAX.
HSC5030-R68M-G/B	0.68	8.0	14.0	11	12.0
HSC5030-1R0M-G/B	1	7	12.0	13	14.0
HSC5030-1R2M-G/B	1.2	6.5	11.0	15	16.0
HSC5030-1R5M-G/B	1.5	5.5	10.0	20	25.0
HSC5030-2R2M-G/B	2.2	5.0	9.0	29	35.0
HSC5030-3R3M-G/B	3.3	4.0	7.0	32	38.0
HSC5030-4R7M-G/B	4.7	3.0	6.0	50	60
HSC5030-6R8M-G/B	6.8	2.5	4.0	91	108.0
HSC5030-100M-G/B	10	1.5	3.0	115	150

*: you require another part number please contact with us.

**: Inductance Tolerance ± 20%

Note 1: All test data is referenced to 25°C ambient.

Note 2: I_{dc} : DC current (A) that will cause an approximate ΔT of 40°C

Note 3: I_{sat} : DC current (A) that will cause L_o to drop approximately 30%

SMD POWER INDUCTORS:

HSC-5030M Series

1. Reel Dimension

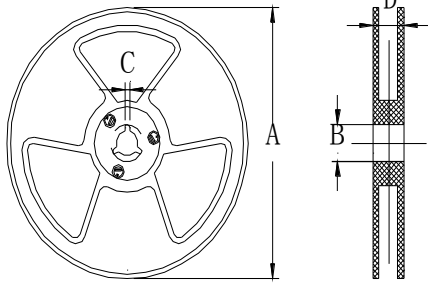

规格尺寸	13"
A	$\Phi 330 \pm 2.0\text{mm}$
B	$\Phi 76.5 \pm 2.0\text{mm}$
C	2.3mm
D	$12 \pm 0.2\text{mm}$ (载带 9.3mm)

2. Tape Dimension

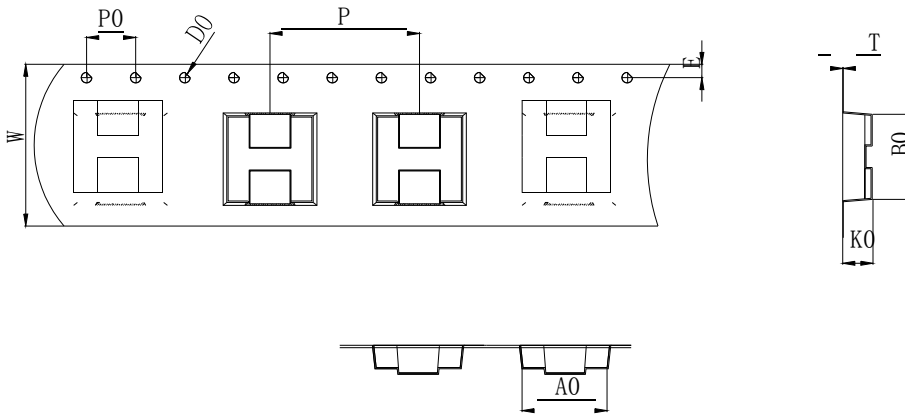

Size	W (mm)	A0 (mm)	B0 (mm)	D0 (mm)	E (mm)	K0 (mm)	P0 (mm)	P (mm)	T (mm)
5030	12.0 ± 0.3	5.5 ± 0.1	6.0 ± 0.1	1.5 ± 0.1	1.75 ± 0.1	3.0 ± 0.1	4.0 ± 0.1	8.0 ± 0.1	0.3 ± 0.05

3. Packaing Quantity

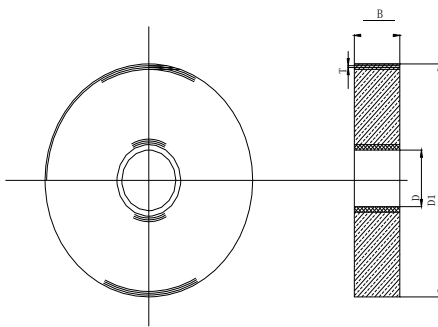

包装单位	包装尺寸	包装数量
1 盘	330*12.5mm	2000pcs
1 盒3 盘	34*6.5*34cm	6000pcs
1 箱2 盒	35.5*28.5*36.5cm	12000pcs